

Laundry Room Layouts

These layouts show the minimum space recommended for the equipment mix included and are intended for use as a guideline only.

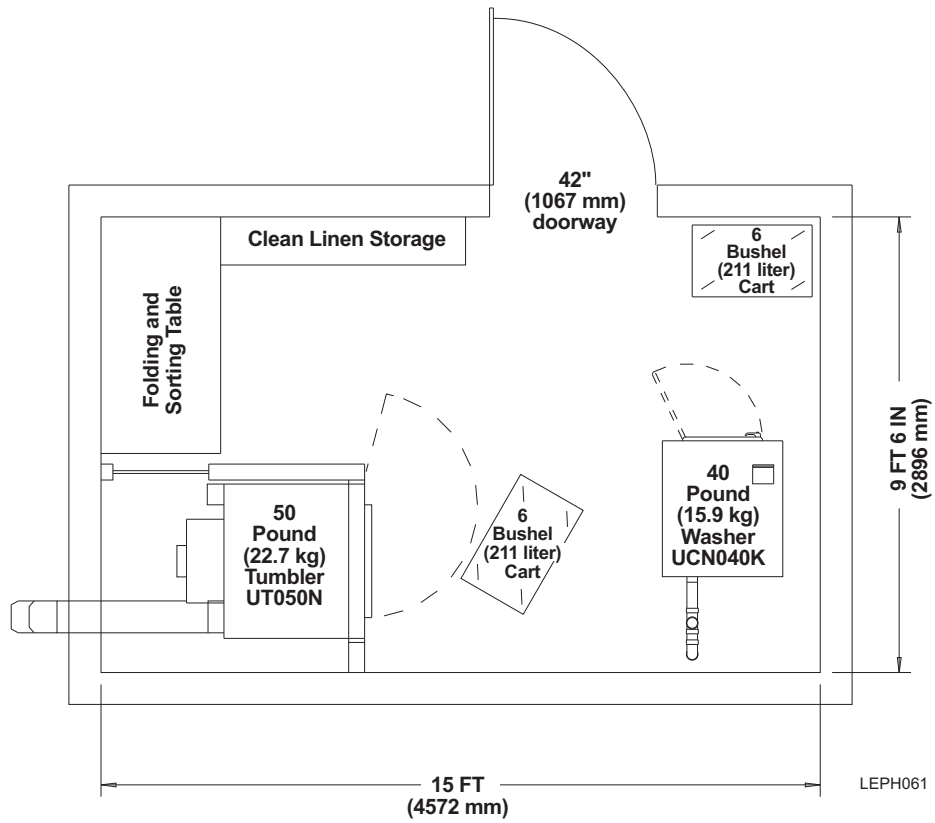

Typical Laundry for No-Iron Linen
Capable of Producing 53 Pounds (24 kg) Per Hour
(142.5 Square Feet [13.2 Square Meters])

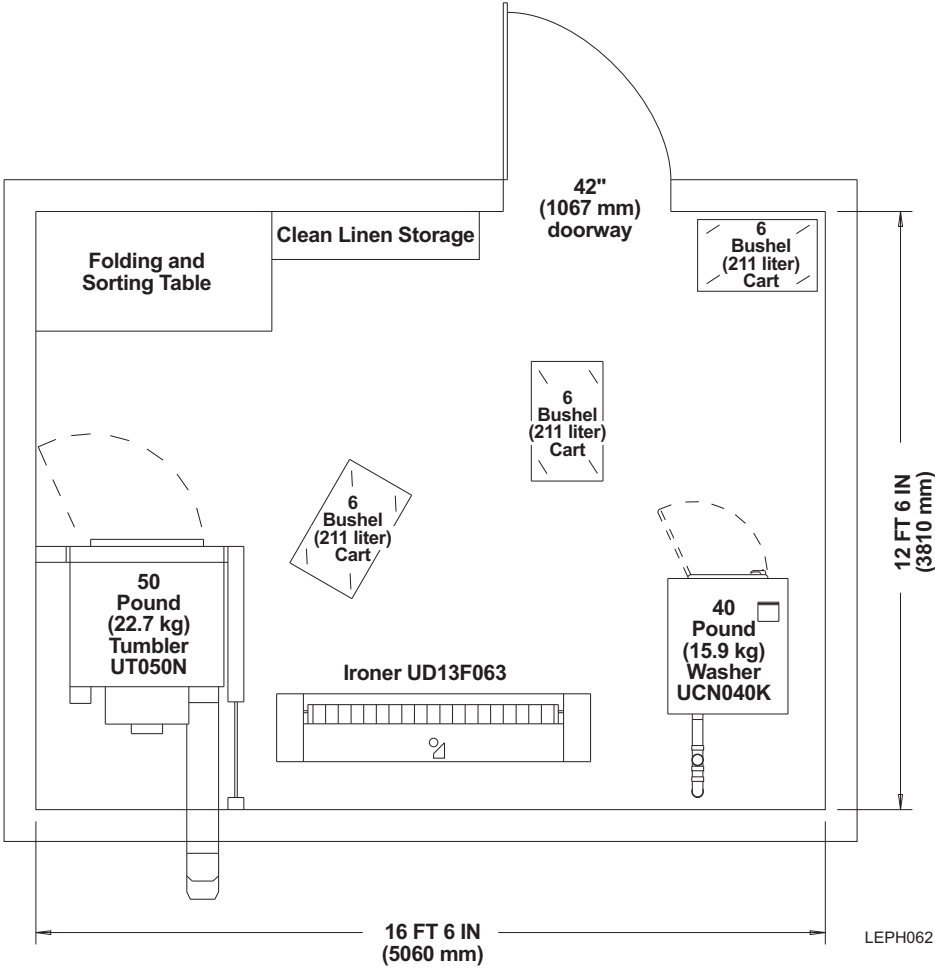

Typical Laundry with Ironer for Flatgoods
Capable of Producing 53 Pounds (24 kg) Per Hour
(206.3 Square Feet [19.2 Square Meters])

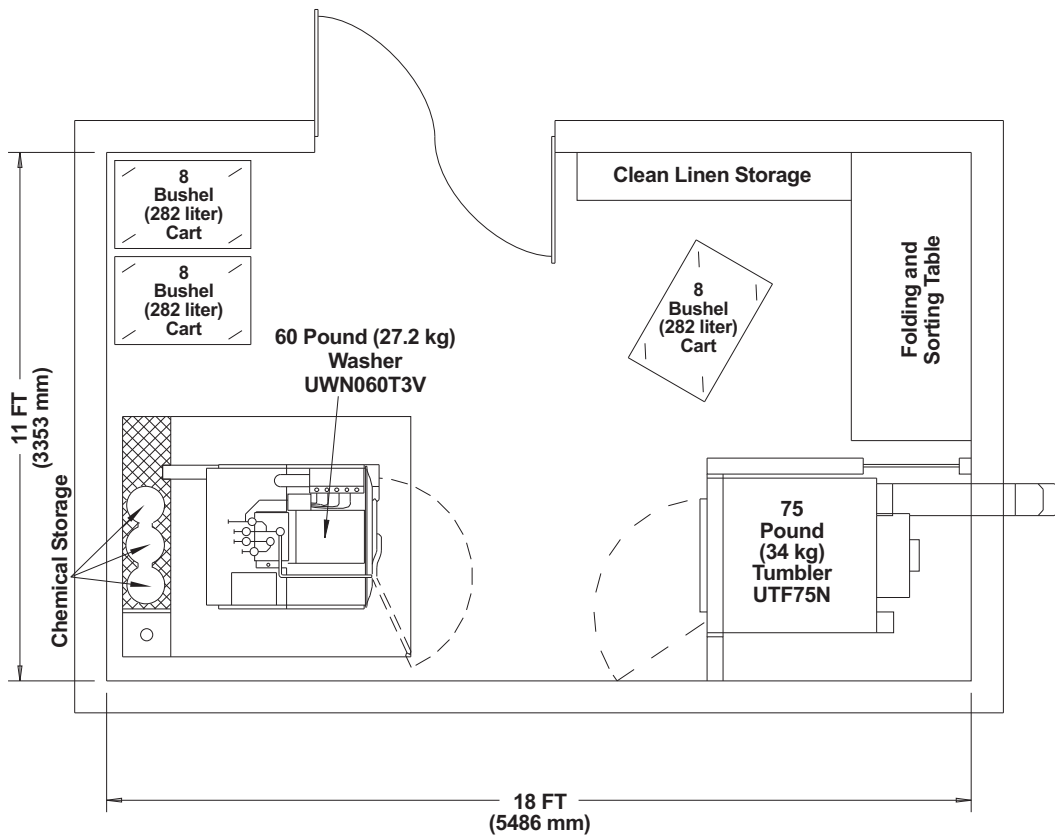

LEPH203

Typical Laundry for No-Iron Linen
Capable of Producing 90 Pounds (41 kg) Per Hour
(198 Square Feet [18.4 Square Meters])

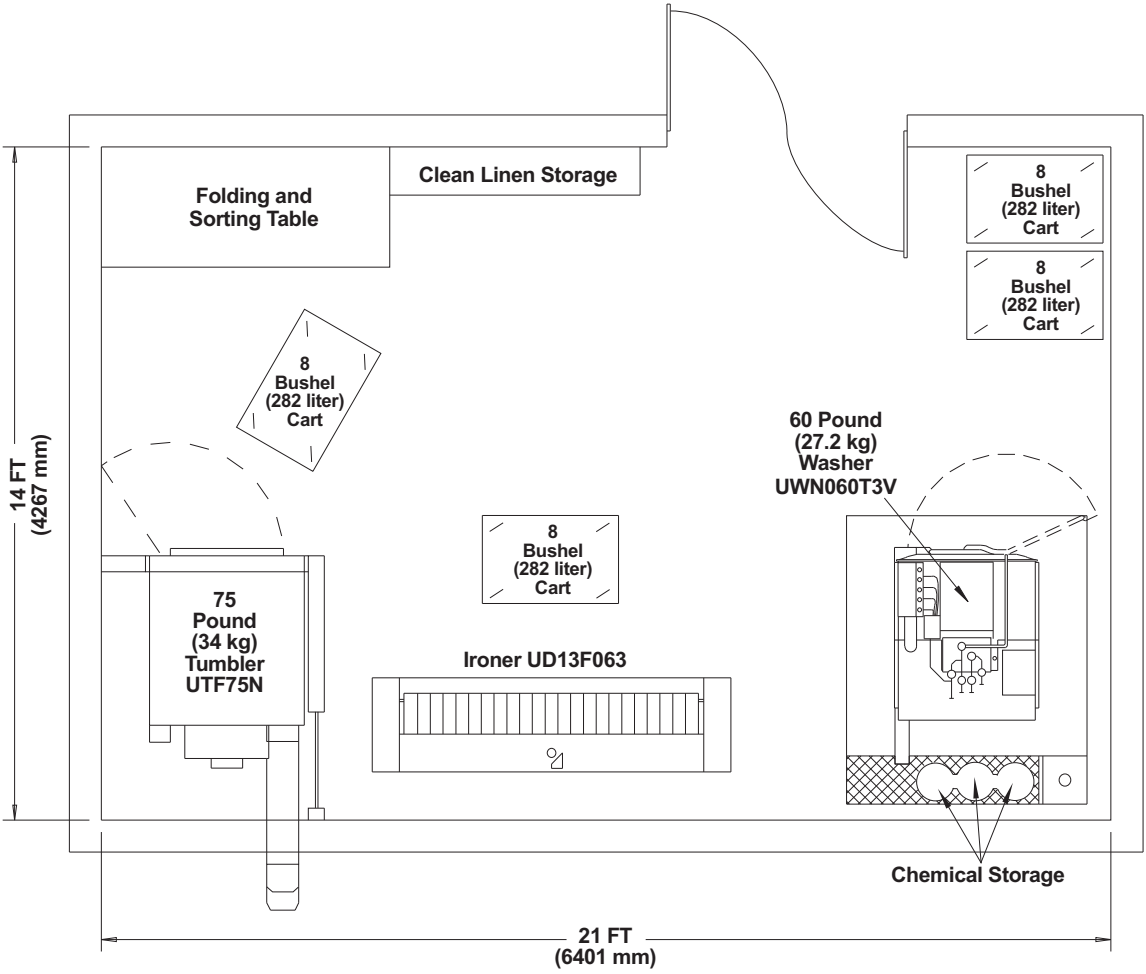

LEPH204

Typical Laundry with Ironer for Flatgoods
Capable of Producing 90 Pounds (41 kg) Per Hour
(294 Square Feet [27.3 Square Meters])

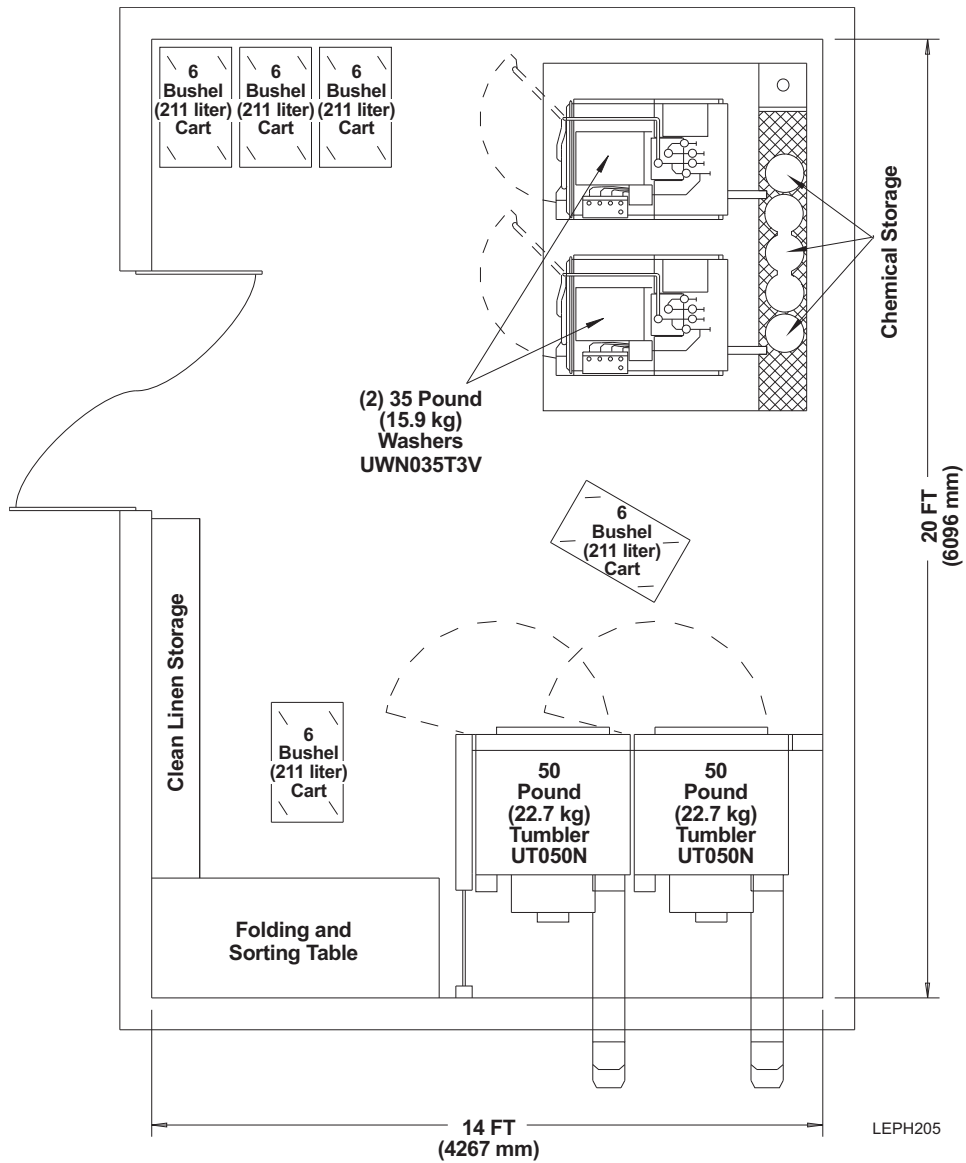

Typical Laundry for No-Iron Linen
Capable of Producing 105 Pounds (48 kg) Per Hour
(280 Square Feet [26.0 Square Meters])

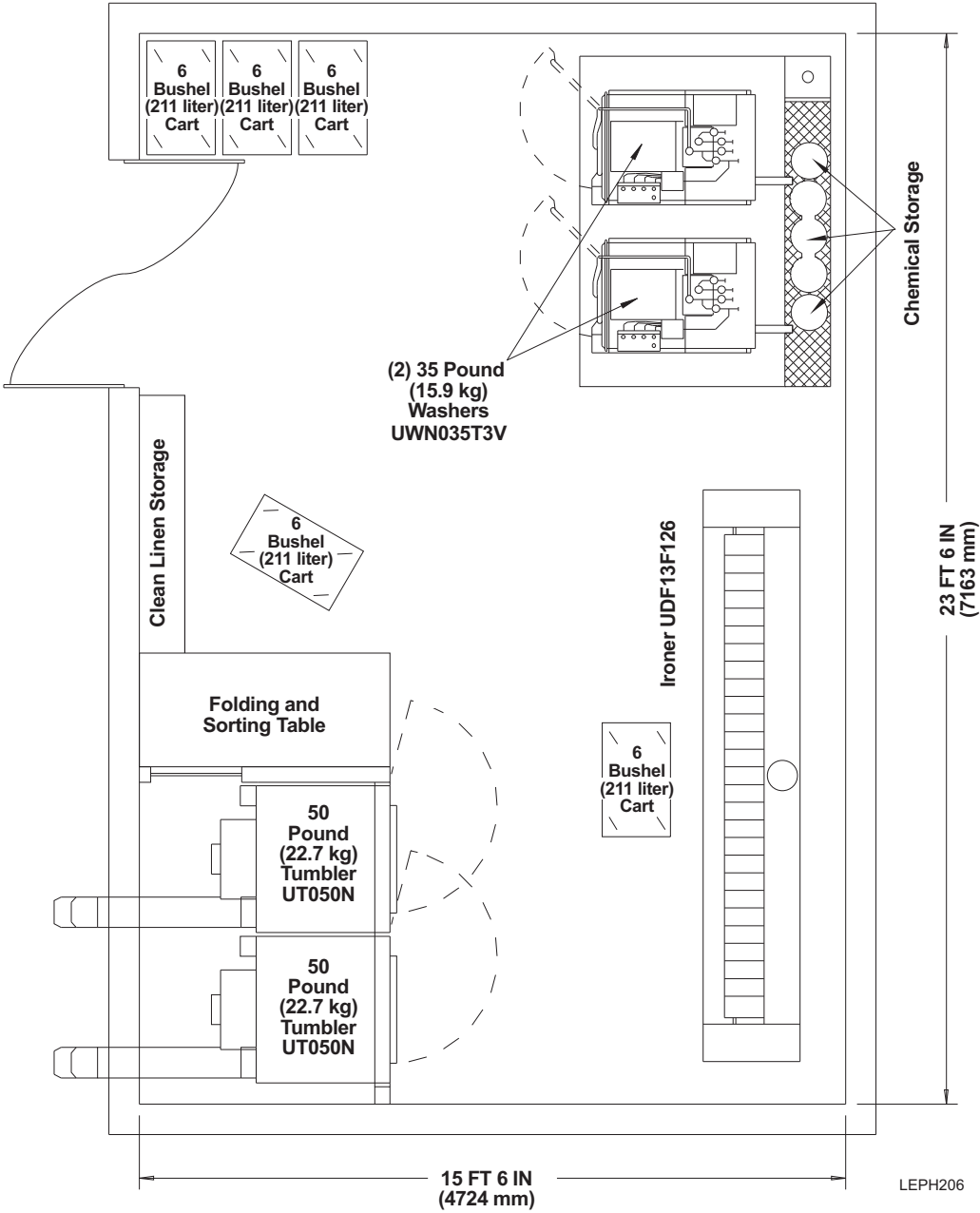

Typical Laundry with Ironer for Flatgoods
Capable of Producing 105 Pounds (48 kg) Per Hour
(364.3 Square Feet [33.8 Square Meters])

Section 3 - Laundry Room Layouts

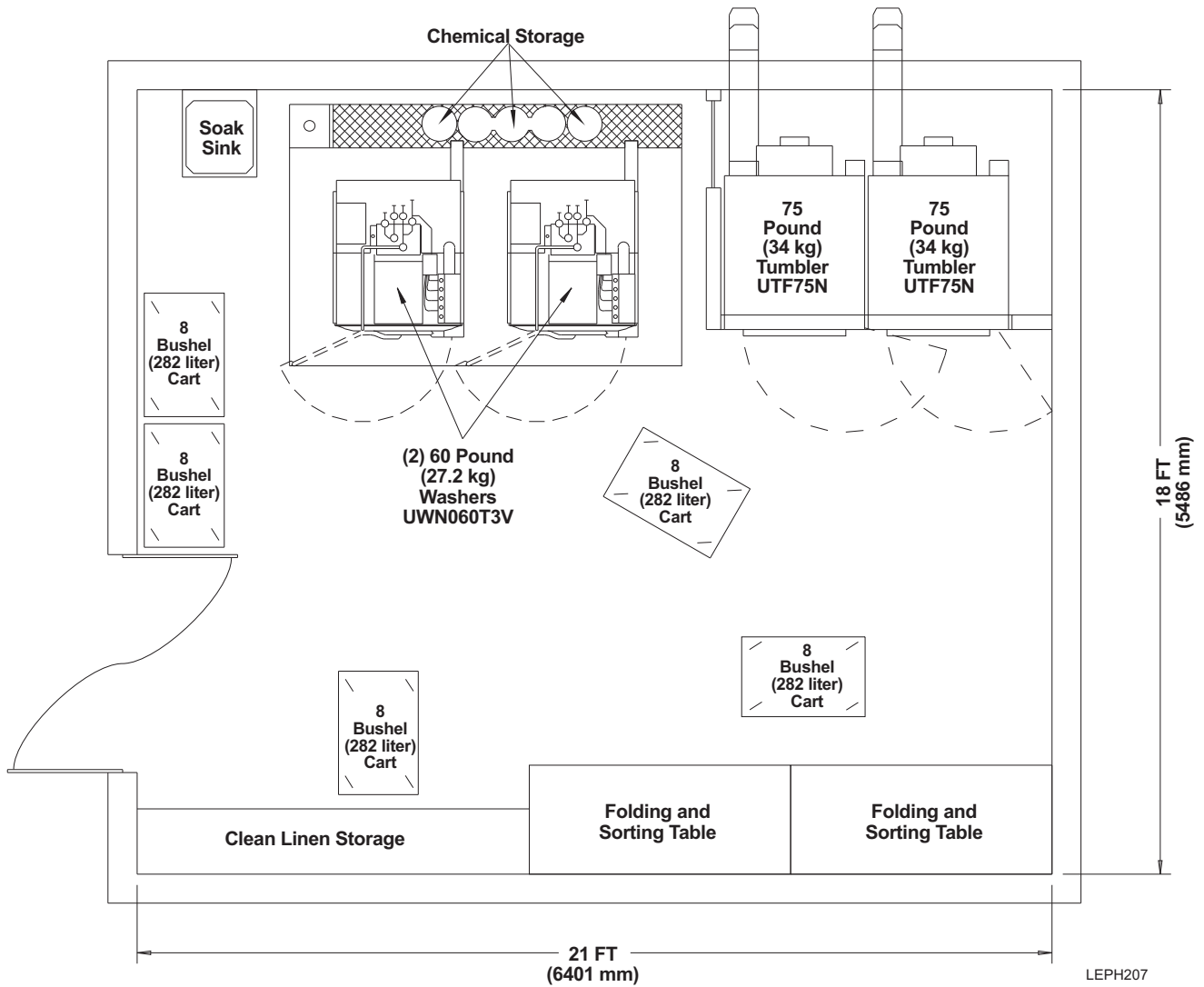

Typical Laundry for No-Iron Linen
Capable of Producing 180 Pounds (82 kg) Per Hour
(378 Square Feet [35.1 Square Meters])

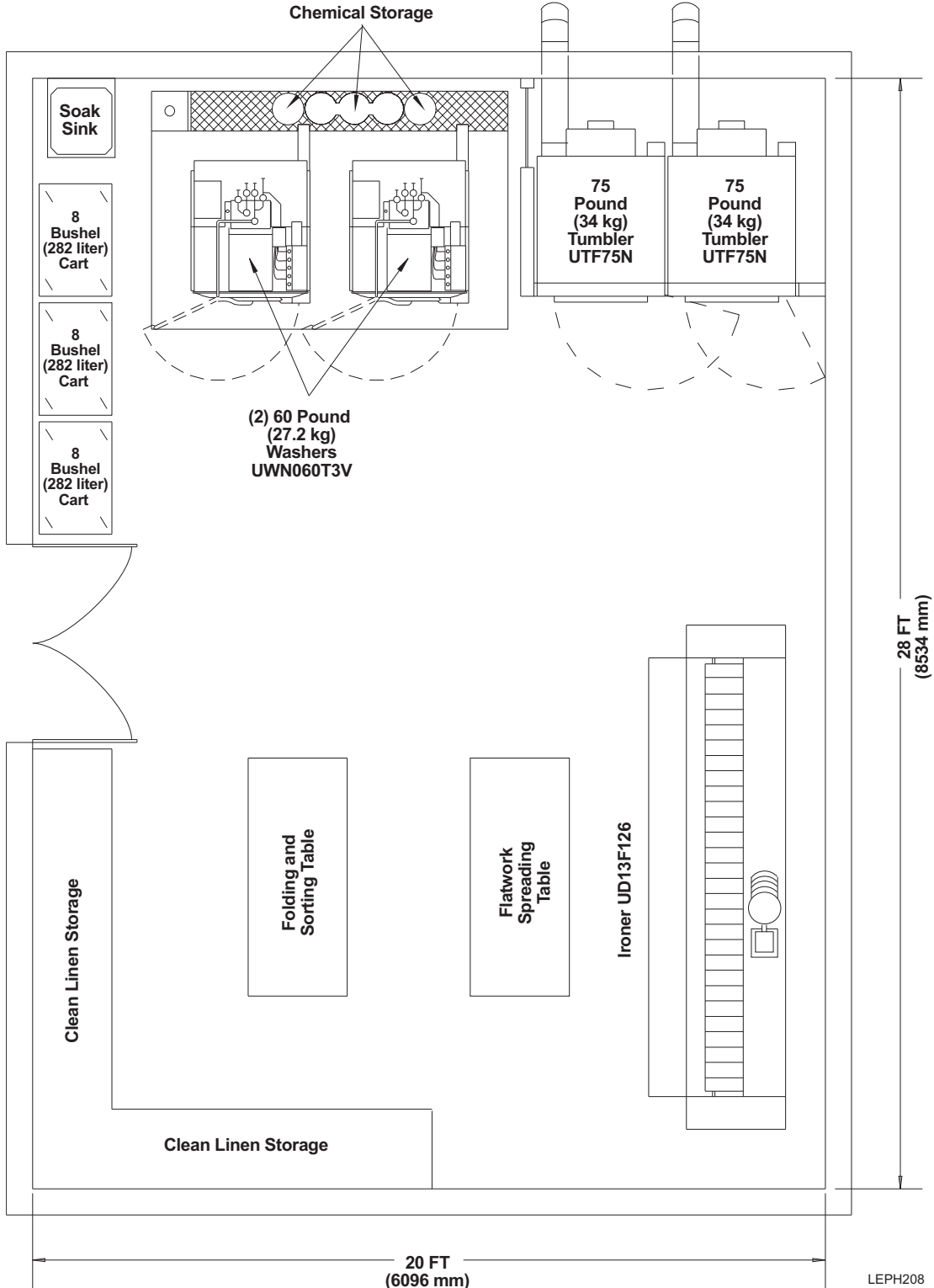

Typical Laundry with Ironer for Flatgoods
Capable of Producing 180 Pounds (82 kg) Per Hour
(560 Square Feet [52.0 Square Meters])

Section 3 - Laundry Room Layouts

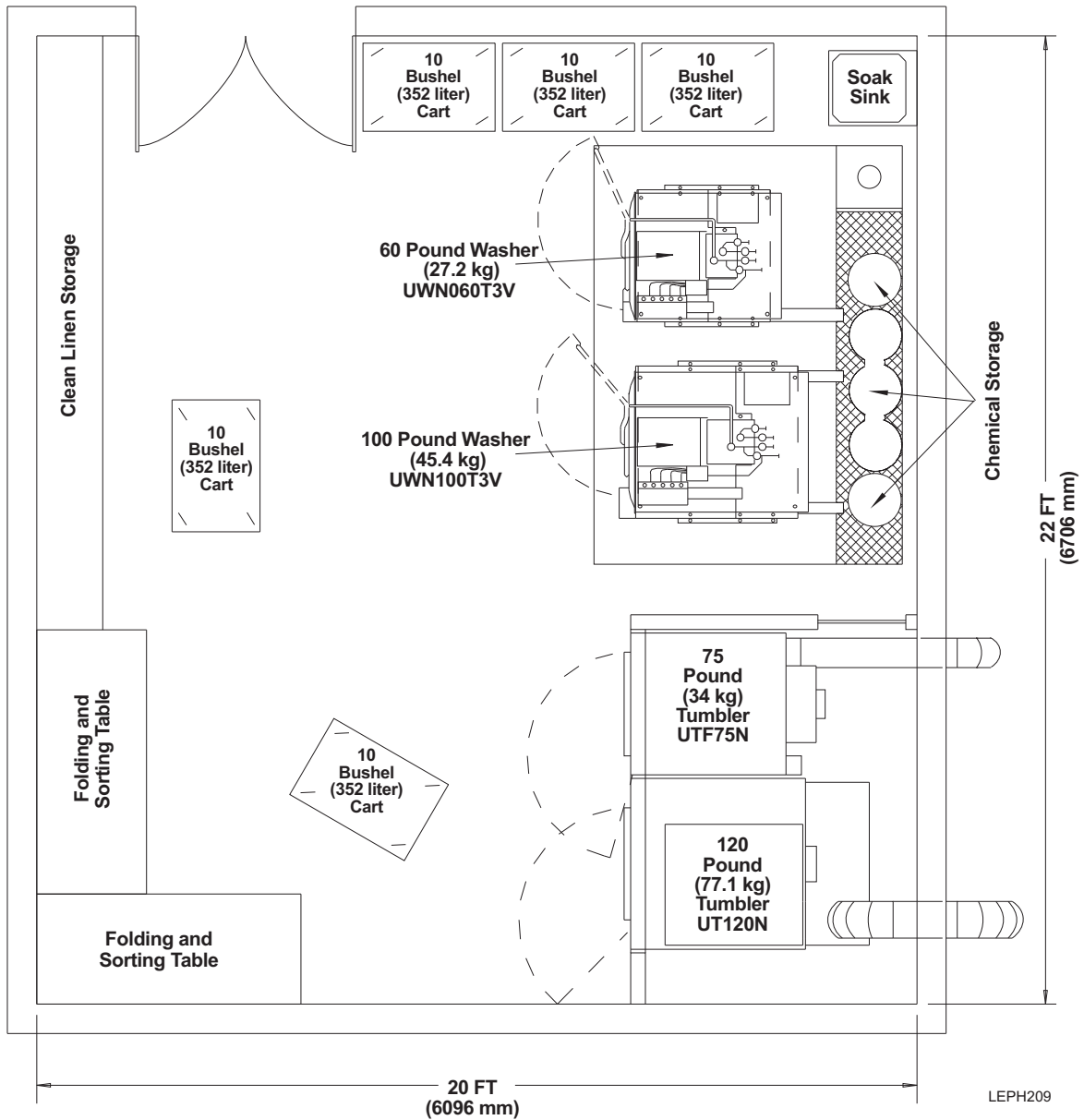

Typical Laundry for No-Iron Linen
Capable of Producing 240 Pounds (109 kg) Per Hour
(440 Square Feet [40.9 Square Meters])

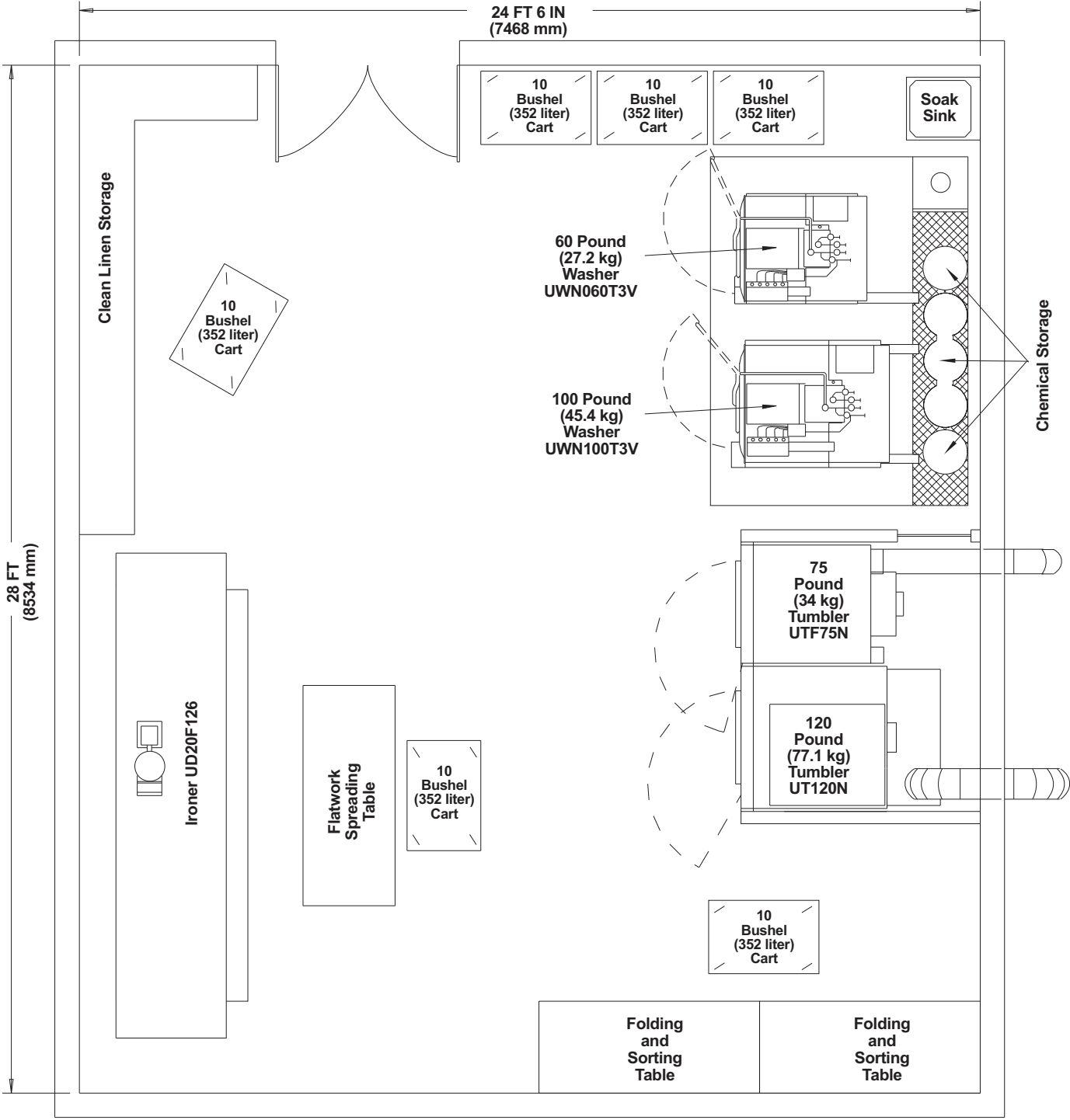

LEPH210

Typical Laundry with Ironer for Flatgoods
Capable of Producing 240 Pounds (109 kg) Per Hour
(686 Square Feet [63.7 Square Meters])

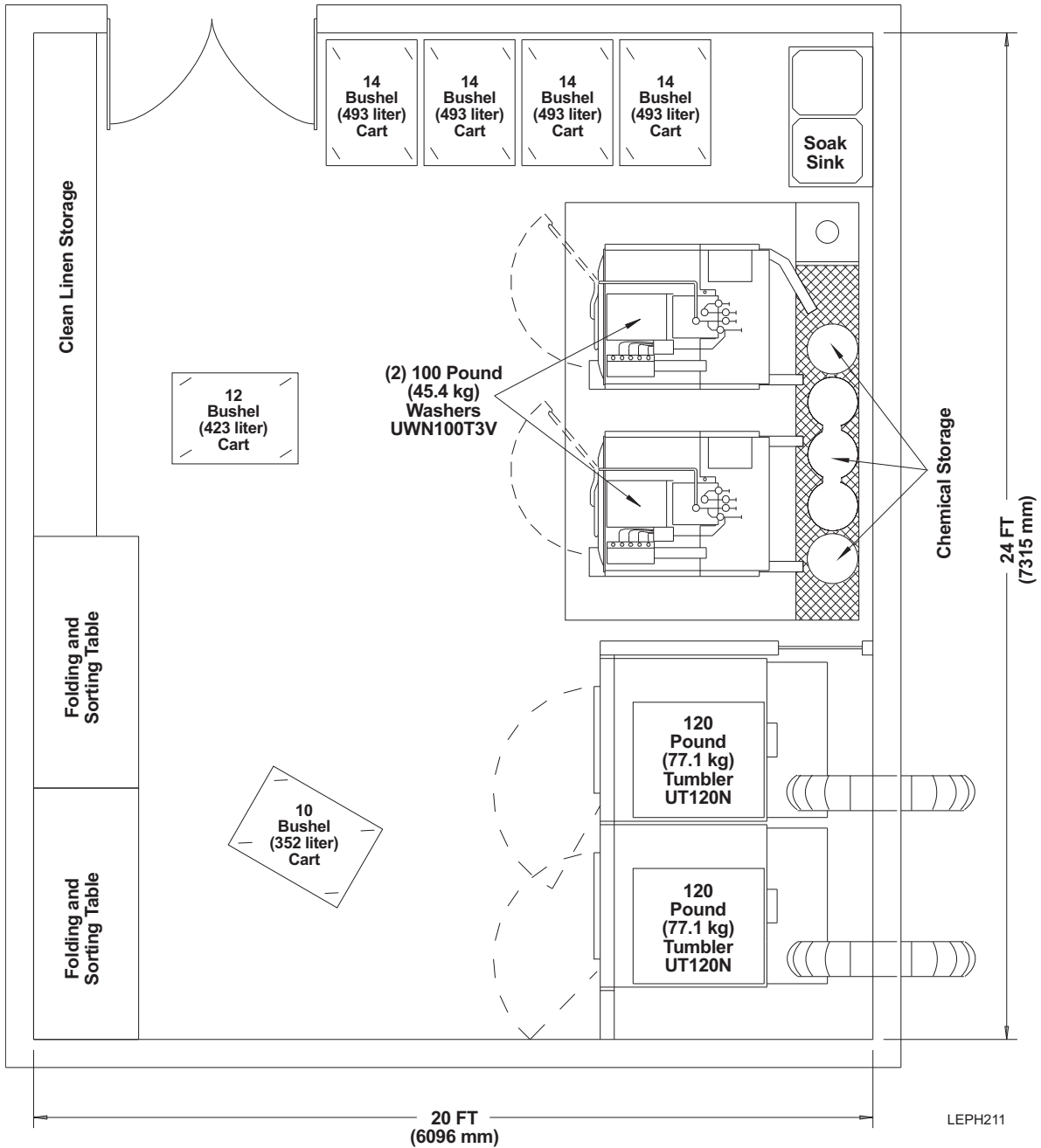

Typical Laundry for No-Iron Linen
Capable of Producing 300 Pounds (136 kg) Per Hour
(480 Square Feet [44.6 Square Meters])

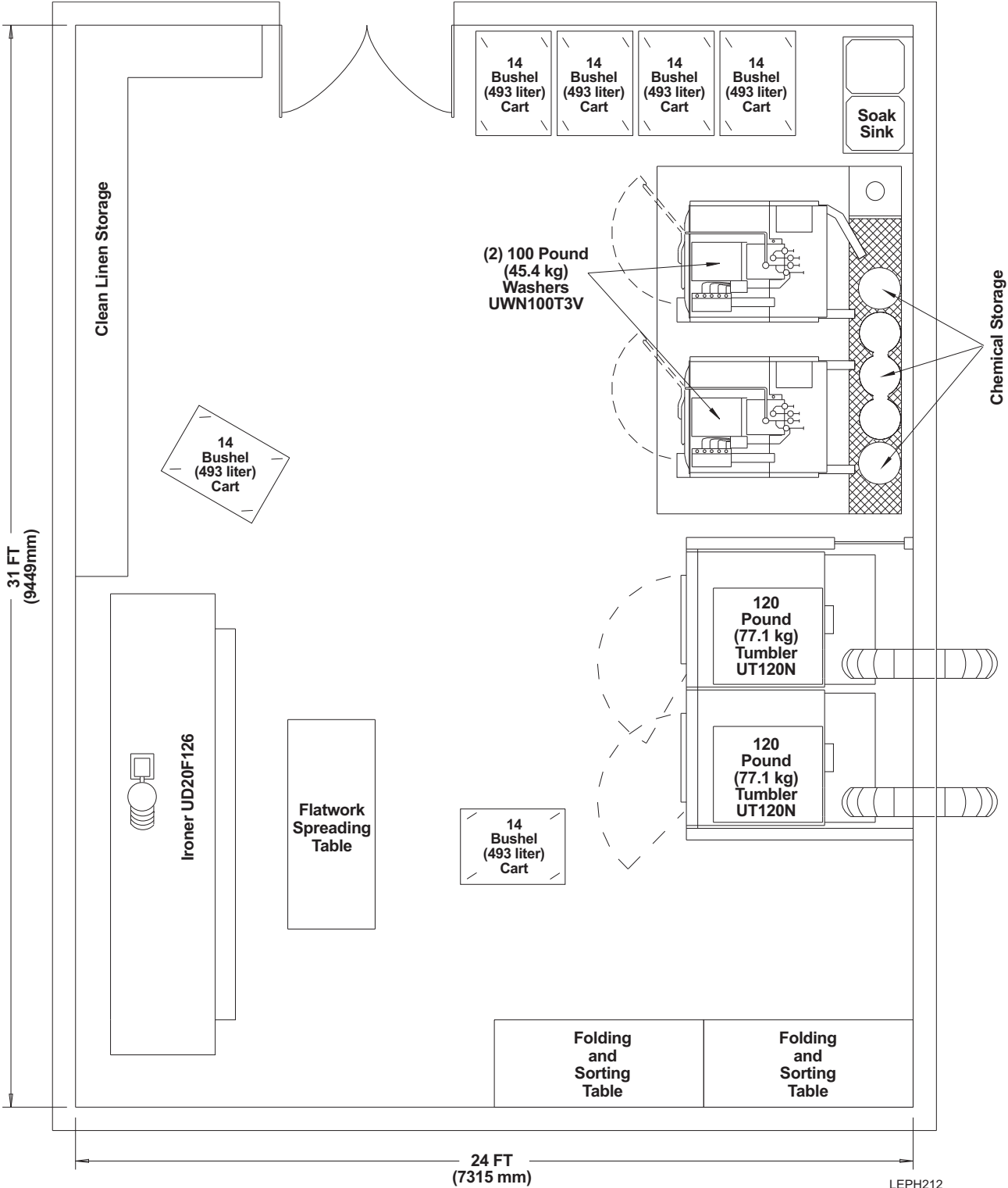

Typical Laundry with Ironer for Flatgoods
Capable of Producing 300 Pounds (136 kg) Per Hour
(744 Square Feet [69.1 Square Meters])

Section 3 - Laundry Room Layouts

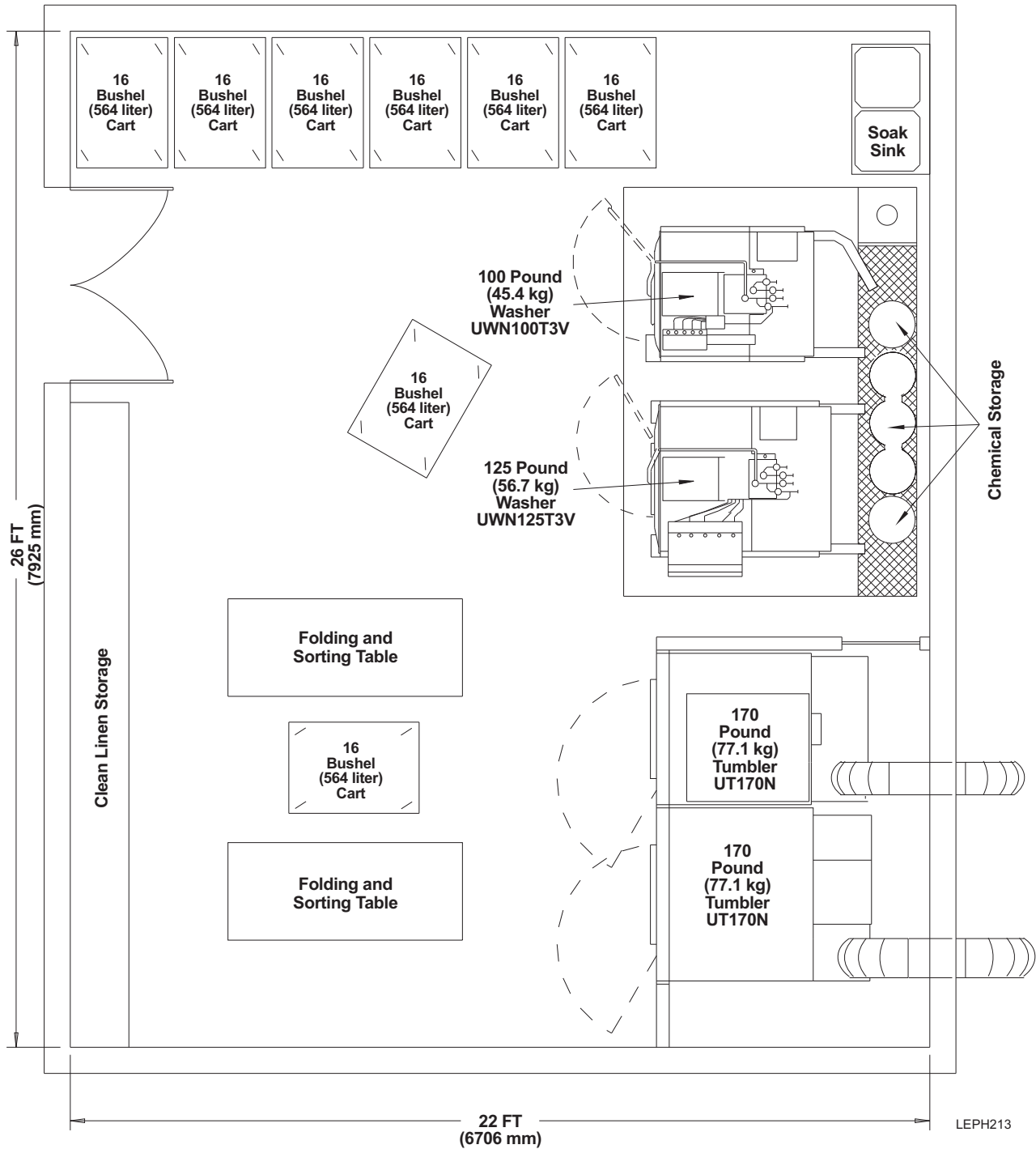

Typical Laundry for No-Iron Linen
Capable of Producing 337 Pounds (153 kg) Per Hour
(572 Square Feet [53.1 Square Meters])

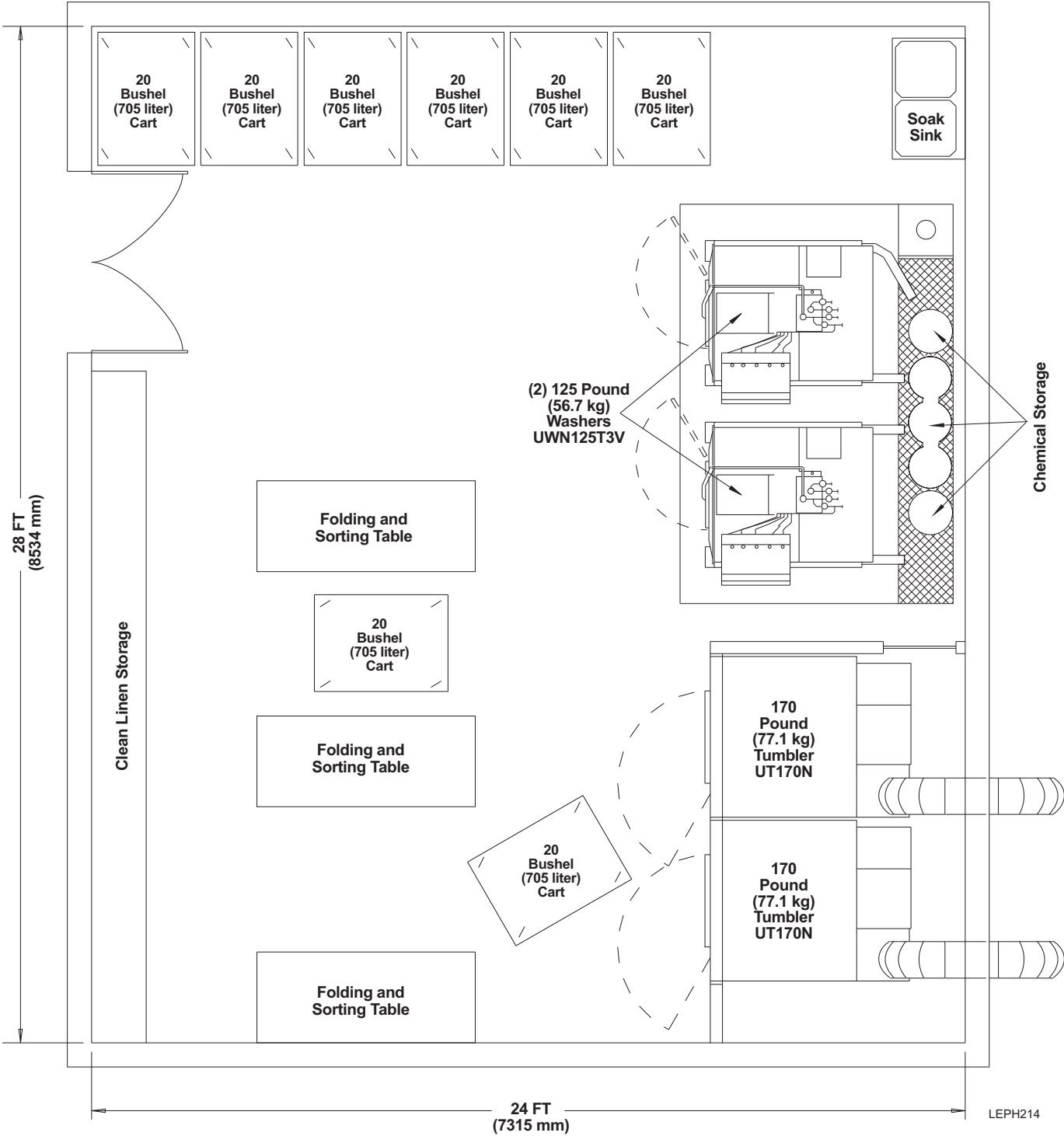

Typical Laundry for No-Iron Linen
Capable of Producing 375 Pounds (170 kg) Per Hour
(672 Square Feet [62.4 Square Meters])

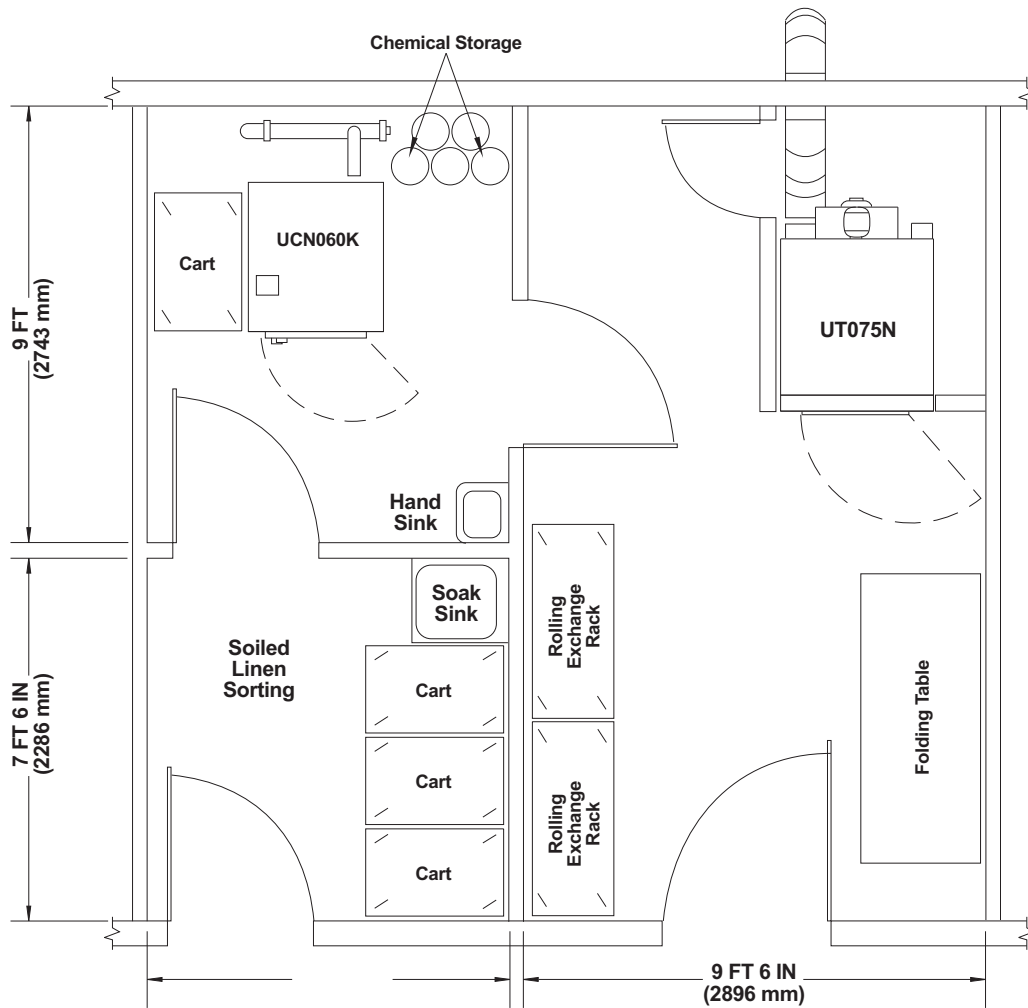

LEPH076

Typical Laundry for 50 Bed Assisted Living Retirement Center
(280.5 Square Feet [26 Square Meters])

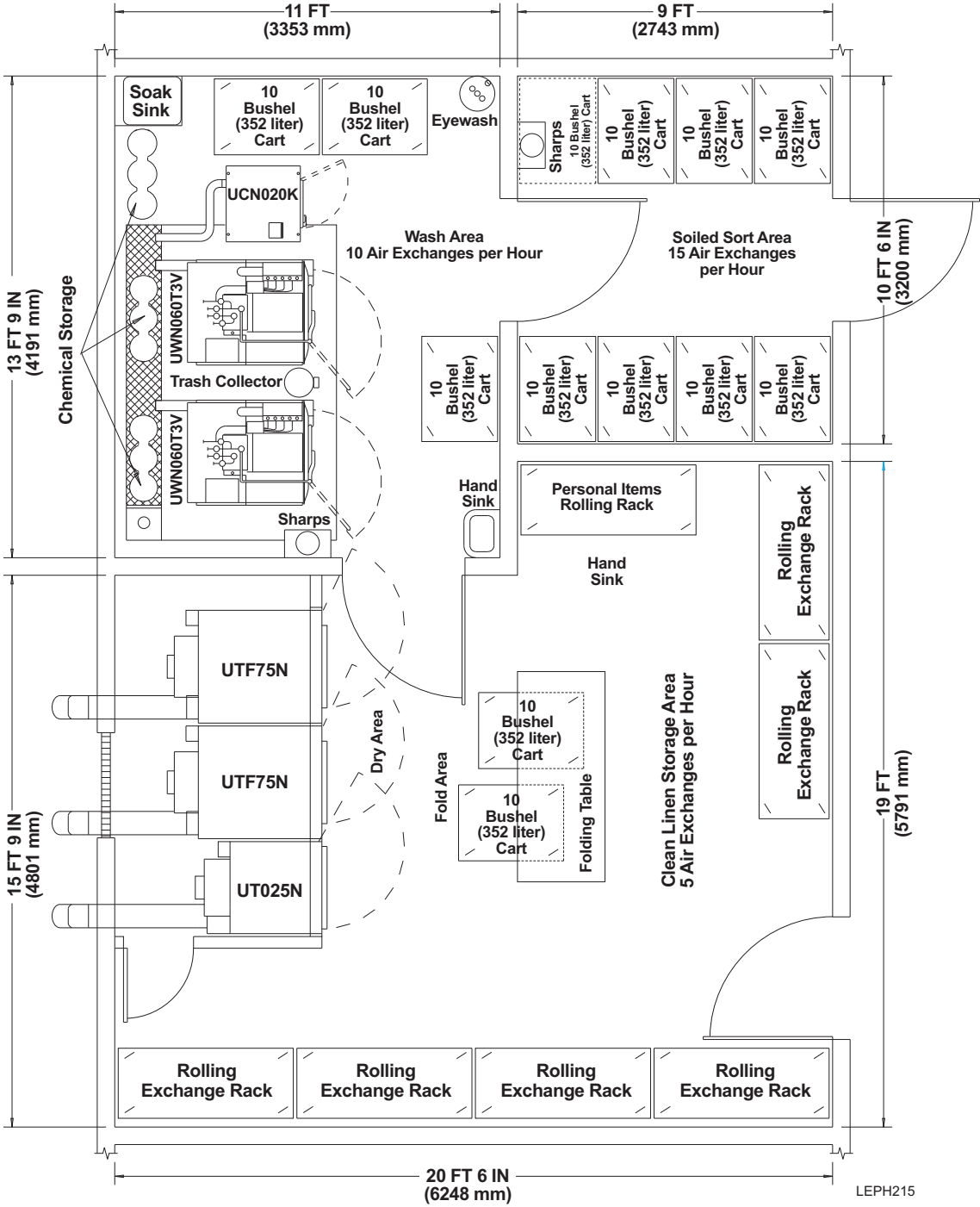

LEPH215

Typical Laundry for a Nursing Home
 Capable of Producing 166 Pounds (75 kg) Per Hour at 1.2 Loads Per Hour
 (604.8 Square Feet [56 Square Meters])

Section 3 - Laundry Room Layouts

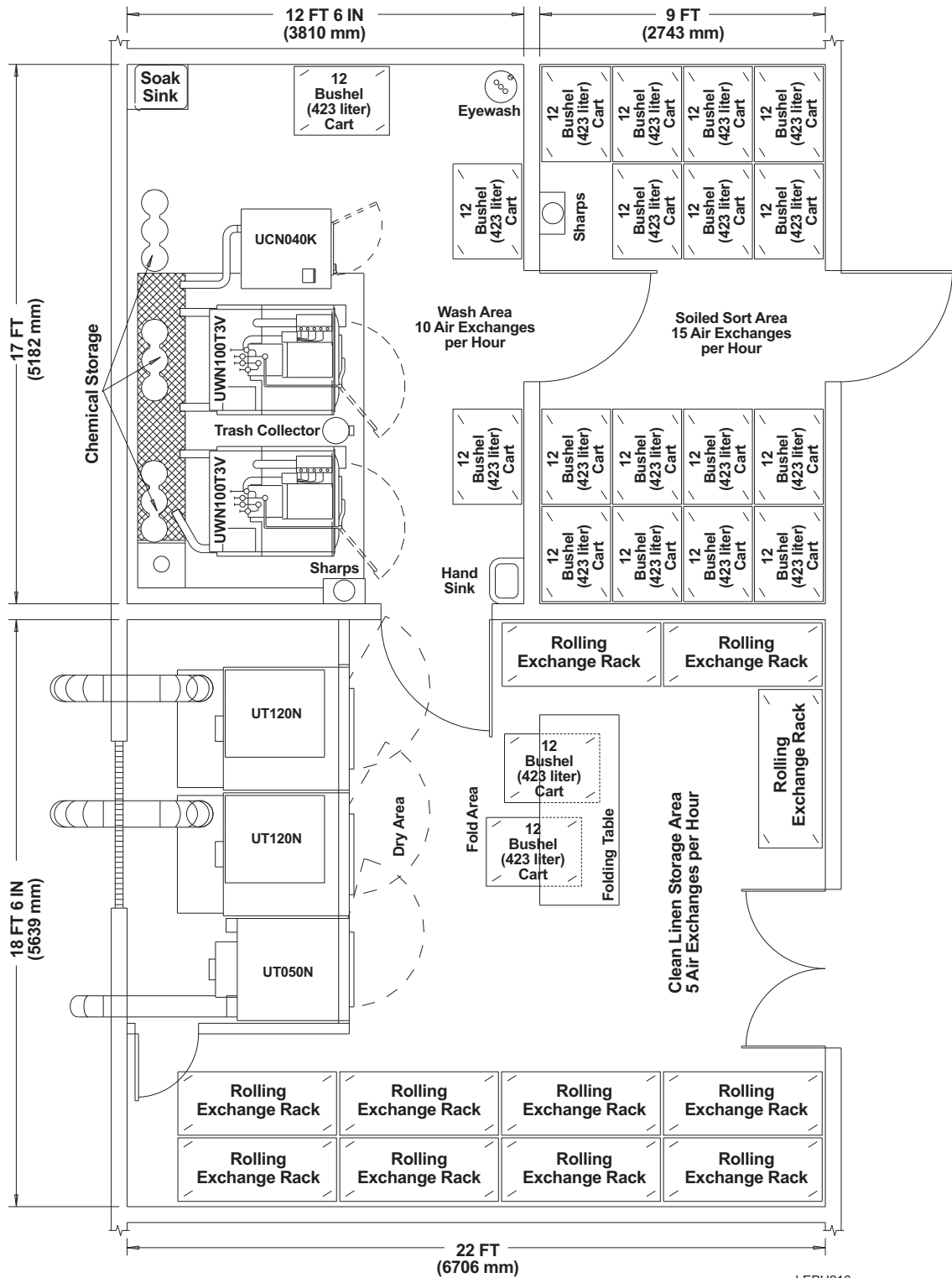

LEPH216

Typical Laundry for a Nursing Home
 Capable of Producing 282 Pounds (128 kg) Per Hour at 1.2 Loads Per Hour
 (781 Square Feet [72.5 Square Meters])